



MOUNTING BRACKET KIT INSTALLATION INSTRUCTIONS

ROADMASTER, INC.

5602 N.E. SKYPORT WAY

PORTLAND, OR 97218

1-800-669-9690 FAX (503) 288-8900

PARTS LIST:

- 1- RECEIVER BRACE (A) - Passenger side
- 1- RECEIVER BRACE (B) - Driver's side
- 1- FRONT BRACE (C) - Passenger side
- 1- FRONT BRACE (D) - Driver's side

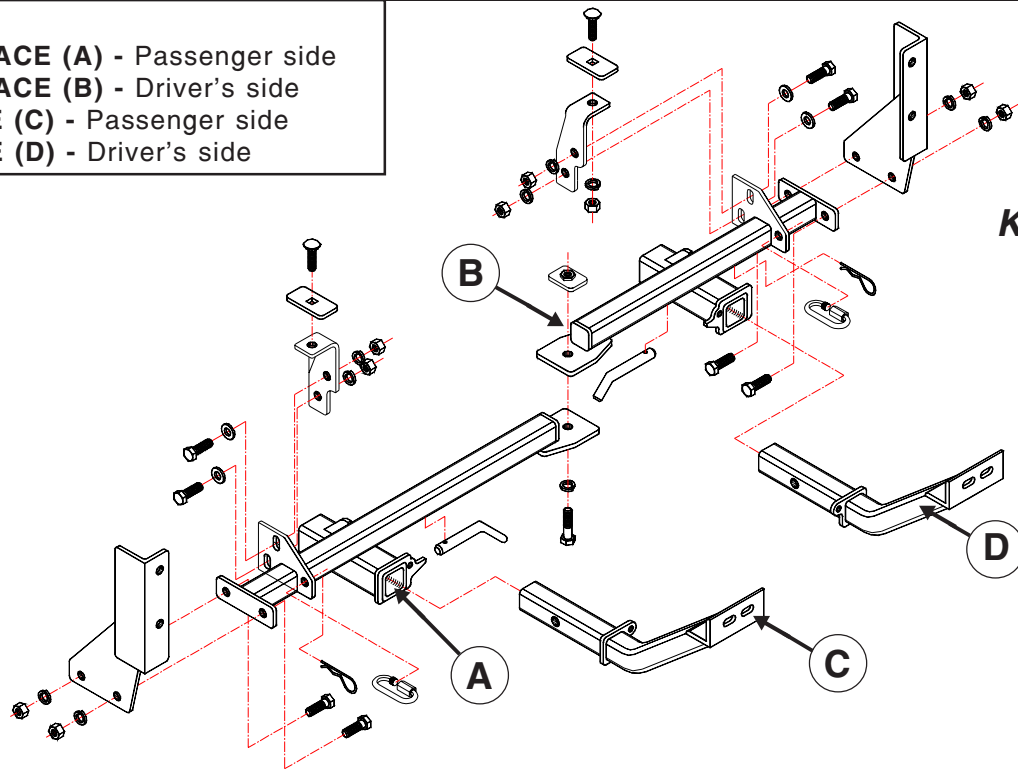

KIT NO. 240-2

072398

IMPORTANT: All brackets **must** be assembled with all the bolts left loose for final adjustment & positioning (before tightening) unless otherwise instructed. All bolts **must** be torqued for proper strength. If more than one bolt is used per fastening point, the diagram may only show one.

- Use flat washers over all slotted holes
- Use lock washers on all fasteners

ROADMASTER Limited Warranty, including One-Year Conditional Warranty Text and Product Registration Card, in Carton.

WARNING

- Do not use this document for custom fabrication as it may not show all parts or structural components.
- ROADMASTER will not be responsible for any damage or injury resulting from any modification or alteration.
- The owner must inspect all mounts and brackets before each use for cracks or other signs of fatigue. Also, inspect the fasteners for proper torque, according to the torque chart.
- The owner must check the manufacturer's instructions for the proper procedure(s) to prepare the vehicle for towing. Some vehicles must be equipped with a transmission lube pump, an axle disconnect, driveline disconnect or free-wheeling hubs before they can be towed. Failure to properly equip the vehicle will cause severe damage to the transmission.
- The installer must read the instructions and use all bolts and parts supplied.
- If the towed vehicle has been in an accident, it must be properly repaired before attaching the brackets. Do not install the brackets if any structural frame damage is found. Failure to repair the damage may result in loss of your towed vehicle.
- Some motorhome chassis have such a tight turning radius that you can damage your motorhome, towed vehicle or tow bar while turning sharply. Before getting on the road, test your turning radius in an empty parking lot. Damage that results from turning too sharply is not covered by warranty.
- The driver must not back up the motorhome with the towed vehicle attached or non-warranty damage will occur to your towing system or towed vehicle.
- The safety cables must connect the towing vehicle to the towed vehicle frame to frame, with the cables crossed. Refer to the cable instructions for proper routing.
- Make sure there is enough slack in the safety cables at the motorhome to allow for sharp turns.
- Use caution when handling the tow bar — if your hands, fingers or any part of your body are caught between moving components, they can be pinched, cut or otherwise injured.
- This bracket is designed for use with ROADMASTER tow bars and ROADMASTER adaptors. Using this bracket with other brands, without an approved ROADMASTER adaptor, may result in non-warranty damage or injury.
- Important! This bracket is only warranted for the original installation. Installing a used bracket on another vehicle is not recommended and will void the warranty.
- Upon final installation, the installer must inspect the bracket to ensure adequate clearance, particularly around hoses, AC lines, radiators, etc., or non-warranty damage will result.



WARNING

Failure to follow these instructions can result in property damage, personal injury or even death.

MOUNTING BRACKET KIT INSTALLATION INSTRUCTIONS

ROADMASTER, INC. 5602 N.E. SKYPORT WAY PORTLAND, OR 97218 1-800-669-9690 FAX (503) 288-8900

KIT NO. 240-2

1. This bracket kit utilizes existing bumper mount bolts, the motor mount bracket and frame as mounting points. The kit consists of two side braces which bolt to the bumper mount bolts, two tubular center braces which bolt to the motor mount and side braces and small upper frame braces which bolt to the frame on each side and the tubular center braces. Two front tubular braces insert into receivers which are located under the front bumper. Work on one side at a time starting with the drivers side.
2. Look behind the bumper in the wheel well and find two large shoulder nuts which secure the front bumper mounting bracket. Remove the shoulder nuts and slide the side brace over the bumper bolts. Replace the nuts and tighten finger tight.
3. Take a 1/4" x 1-1/2" x 3" backing plate and a 1/2" x 1-1/2" carriage bolt and insert through the front inside of the inner frame in to the existing hole in the bottom of the frame. Bolt the small angle braces to the frame as illustrated using a 1/2" nut and lock washer. Tighten finger tight.
4. Follow steps 2 and 3 for the passenger side.
5. Take the shorter tubular center brace and bolt to the driver side, angle brace and side brace. Use four 1/2" x 1-1/2" bolts, a flat washer, lock washers and nuts.
6. Follow step 5 for the passenger side then insert the threaded 1/4" x 1-1/4" x 2" backing plate into the motor mount over the unused lower hole and bolt through both tubular center braces using a 5/8" x 2" bolt and lock washer.
7. Align the braces and torque all the bolts to the specifications below.
8. Insert the front braces into the receivers and pin. Mount the tow bar to the front braces following the manufacturer's instructions then torque all bolts to the specifications below.
9. Install the safety cables on the lower receiver braces in the holes provided and then to the tow vehicle.

Hardware:

- | | | |
|--|--|---------------|
| 8- 1/2" x 1-1/2" bolts | 10- 1/2" lock washers | |
| 2- 1/2" x 1-1/2" carriage bolts | 2- 5/8" receiver pins | |
| 1- 5/8" x 2" bolt | 2- spring pins | 072398 |
| 1- 5/8" lock washer | 2- quick couplers | |
| 1- 1/4" x 1-1/4" x 2" threaded backing plate | 2- 13" safety cables | |
| 2- 1/4" x 1-1/2" x 3" backing plates | 1- 1/4" x 2 1/2" x 5 3/4" passenger's side plate | |
| 4- 1/2" flat washers | 1- 1/4" x 2 1/2" x 5 3/4" driver's side plate | |
| 10- 1/2" nuts | | |

CAUTION: Installer must read instructions and use all bolts and parts supplied.

FAILURE TO FOLLOW THESE INSTRUCTIONS CAN RESULT IN DEATH, PERSONAL INJURY OR PROPERTY DAMAGE

BOLT TORQUE REQUIREMENTS

Note: The torque values represented below are intended as general guidelines. Torque requirements for specific applications may vary. Roadmaster does not warrant this information to be accurate for all applications and disclaims all liability for any claims or damages which may result from its use.

STANDARD BOLTS			METRIC BOLTS			METRIC BOLTS		
Thread Size	Grade	Torque	Thread Size	Grade	Plated/Unplated	Thread Size	Grade	Plated/Unplated
5/16	5	13 ft./lb.	8mm-1.0	8.8	20 ft./lb. 18 ft./lb.	12mm-1.25	8.8	70 ft./lb. 65 ft./lb.
3/8	5	23 ft./lb.	8mm-1.25	8.8	19 ft./lb. 18 ft./lb.	12mm-1.5	8.8	66 ft./lb. 61 ft./lb.
7/16	5	37 ft./lb.	10mm-1.25	8.8	38 ft./lb. 36 ft./lb.	12mm-1.75	8.8	65 ft./lb. 60 ft./lb.
1/2	5	56 ft./lb.	10mm-1.5	8.8	37 ft./lb. 35 ft./lb.	14mm-2.0	8.8	104 ft./lb. 97 ft./lb.
5/8	5	150 ft./lb.						

All illustrations and specifications contained herein are based on the latest information available at the time of publication approval. ROADMASTER, INC. reserves the right to make changes at any time without notice in material, specification and models or to discontinue models.